

MULTI - ANGLE STAIR TREAD CUTTING SYSTEM

Want a tool that cuts installation time in half, while side stepping pattern scribing or using tricky technical techniques?

- QUICK, ACCURATE MEASUREMENTS
- USE AS A CUTTING GUIDE WHILE TRANSFERRING STAIR GEOMETRY TO RUBBER TREADS
- ADDITIONALLY USE TO MARK OUT HARDWOODS, TILE, CERAMICS, AND ANY OTHER HARD SURFACE MATERIAL
- PORTABLE AND LIGHTWEIGHT AT 6.5 LBS
- DEPTH ADJUSTMENT FROM 10" TO 13-1/4"
- ADDITIONAL EXTENSION KITS AVAILABLE FOR EXPANDED WIDTHS FROM 22-1/2" TO 9'-1/2"
- ADDITIONAL BLADE FRIENDLY SELF STORAGE BOX DOUBLES AS EXPANDED HEAVY DUTY CUTTING SURFACE
- ERGONOMIC KNOB LAYOUT FOR EASE OF USE
- ALL WALLPLATES ADJUST TO ALL WALL ANGLES
- 1/16" STEEL PLATES FOR MAXIMUM ACCURACY

DOES 1 PIECE
STEP/RISER
TREADS IN
MINUTES

SHOWN:

STANDARD TREADMAN
ADJ. FROM 35 1/4" TO 61 1/2"
SKU: TRDM

EXTENSION KIT 3
ADJ. FROM 22 1/2" TO 36"
SKU: TRDM-EXT3



TOOL BOX/
CUTTING BLOCK
SKU: TRDMBO



THE COMPLETE LINEUP
SKU: TRDM-LINEUP
(COMPLETE LINEUP INCLUDES
TRDM, TRDM-STEPKIT, TRDMBO,
TRDM-EXT1, TRDM-EXT2,
TRDM-EXT3)



STANDARD TREADMAN
WITH
TOOL BOX/
CUTTING BLOCK
SKU:TRDMB1



EXTENSION KIT 1
ADJ. FROM 4' 8 3/8" TO 6' 11"
SKU: TRDM-EXT1



EXTENSION KIT 2
ADJ. FROM 6' 10 3/8" TO 9' 1/2"
SKU: TRDM-EXT2



1 PC STEP/RISER
TEMPLATE KIT
SKU: TRDM-STEPKIT



STEP DOWN
RISER PLATE KIT
SKU: TRD-SDRPK



ASSEMBLY and PARTS

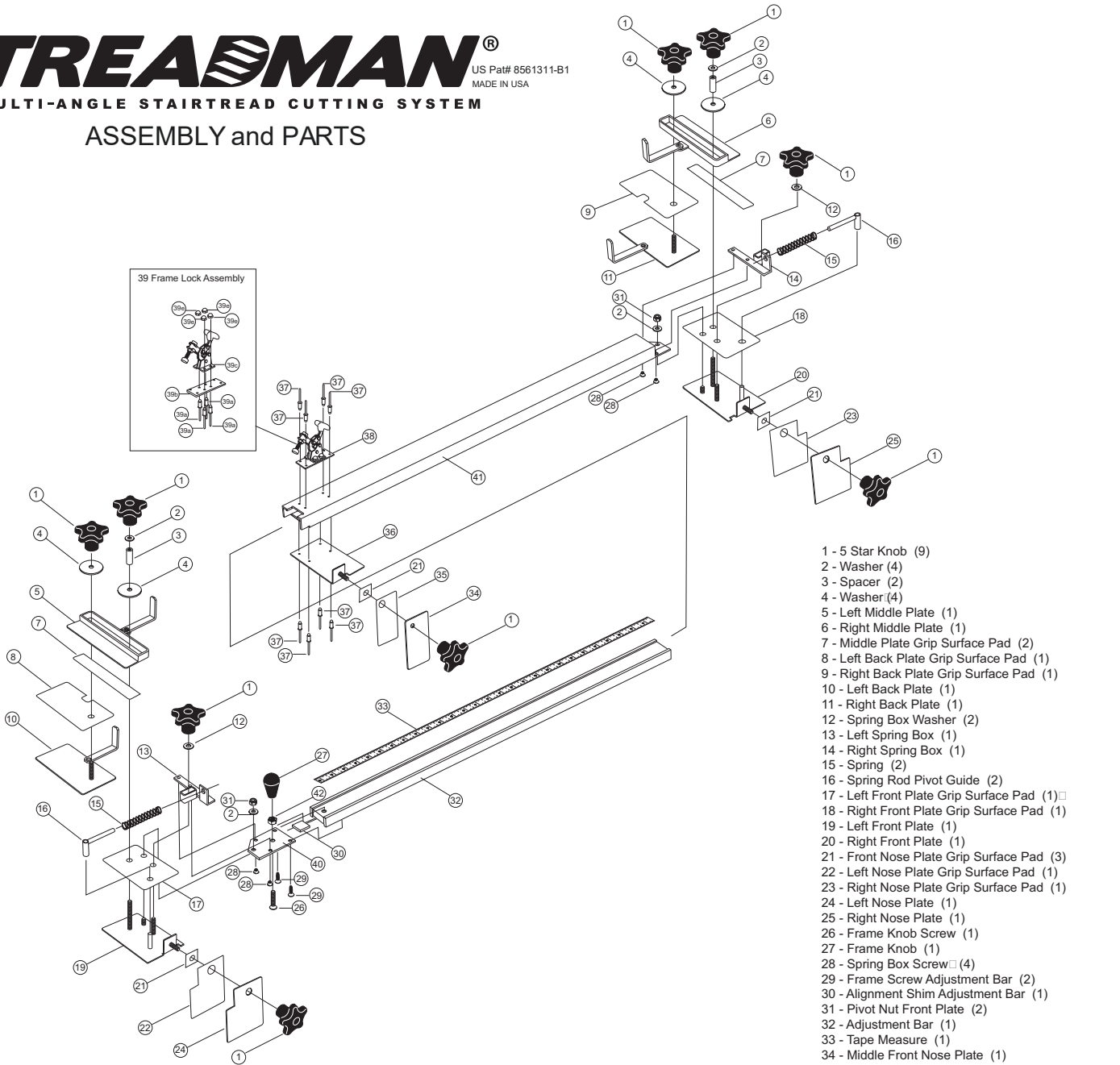

- 1 - 5 Star Knob (9)
- 2 - Washer (4)
- 3 - Spacer (2)
- 4 - Washer (4)
- 5 - Left Middle Plate (1)
- 6 - Right Middle Plate (1)
- 7 - Middle Plate Grip Surface Pad (2)
- 8 - Left Back Plate Grip Surface Pad (1)
- 9 - Right Back Plate Grip Surface Pad (1)
- 10 - Left Back Plate (1)
- 11 - Right Back Plate (1)
- 12 - Spring Box Washer (2)
- 13 - Left Spring Box (1)
- 14 - Right Spring Box (1)
- 15 - Spring (2)
- 16 - Spring Rod Pivot Guide (2)
- 17 - Left Front Plate Grip Surface Pad (1) □
- 18 - Right Front Plate Grip Surface Pad (1)
- 19 - Left Front Plate (1)
- 20 - Right Front Plate (1)
- 21 - Front Nose Plate Grip Surface Pad (3)
- 22 - Left Nose Plate Grip Surface Pad (1)
- 23 - Right Nose Plate Grip Surface Pad (1)
- 24 - Left Nose Plate (1)
- 25 - Right Nose Plate (1)
- 26 - Frame Knob Screw (1)
- 27 - Frame Knob (1)
- 28 - Spring Box Screw □ (4)
- 29 - Frame Screw Adjustment Bar (2)
- 30 - Alignment Shim Adjustment Bar (1)
- 31 - Pivot Nut Front Plate (2)
- 32 - Adjustment Bar (1)
- 33 - Tape Measure (1)
- 34 - Middle Front Nose Plate (1)
- 35 - Middle Front Nose Plate Grip Surface Pad (1)
- 36 - Middle Nose Plate (1)
- 37 - Rivet (8)
- 38 - Frame Lock (1)
- 39 - Frame Lock Assembly (1)
- 39a - Rivets (4)
- 39b - Frame Lock Mounting Plate (1)
- 39c - Frame Lock Clamp (1)
- 39e - Acorn Nuts □ (4)
- 40 - Frame Left (1)
- 41 - Frame Right (1)
- 42 - 1/4"X20 Nylon Nut Spacer (1)

STEP DOWN RISER PLATE KIT

Sold separately

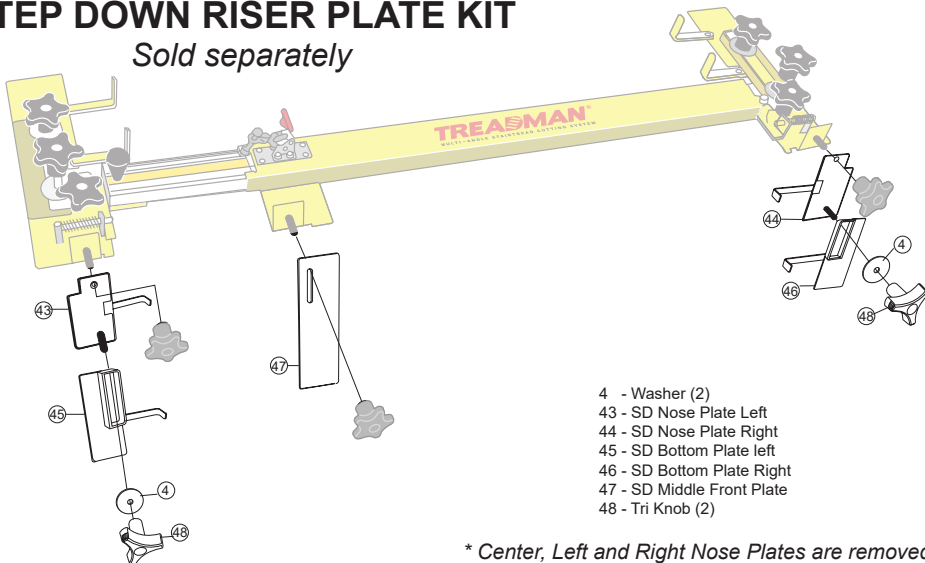

- 4 - Washer (2)
- 43 - SD Nose Plate Left
- 44 - SD Nose Plate Right
- 45 - SD Bottom Plate left
- 46 - SD Bottom Plate Right
- 47 - SD Middle Front Plate
- 48 - Tri Knob (2)

** Center, Left and Right Nose Plates are removed before installing Step Down Riser Plate Kit*



INTRODUCING THE
TREADMAN®

STEP DOWN RISER PLATE KIT

- WORKS WITH THE STANDARD TREADMAN MULTI-ANGLE STAIR TREAD CUTTING SYSTEM
- DESIGNED TO WORK WITH ROPPE'S LVT SIX DEGREES ONE PIECE STEP DOWN RISER TREAD
- ALLOWS USER TO CAPTURE ANGLES OF THE RISER USING ADJUSTABLE STEEL PLATES
- RISER HEIGHT MINIMUM 6 1/8" MAXIMUM 8 1/8"

DISTRIBUTOR PRICING: \$89 USD
SUGGESTED MSRP: \$125 USD
SKU: TRD-SDRPK

* KIT DOES NOT INCLUDE
STANDARD TREADMAN

